

**Christian Reid**  
Estate Agents



**Horsham**

**£850pcm**

Worthing Road, Horsham, RH13 9HE



1 Bedrooms



1 Receptions



1 Bathrooms



Upper Floor



EPC: D

A Spacious & Modern Apartment situated above shops in a central location | Large Double bedroom | Modern Bathroom | Large open plan Living room/Kitchen with built in appliances | Double Glazed, Gas Central Heating | Modern spec throughout | Excellent decorative condition | Available early March | Unfurnished

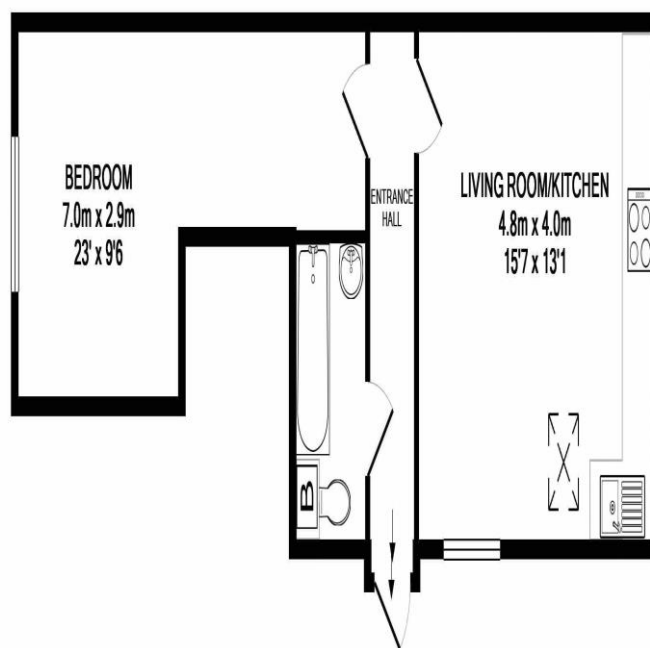
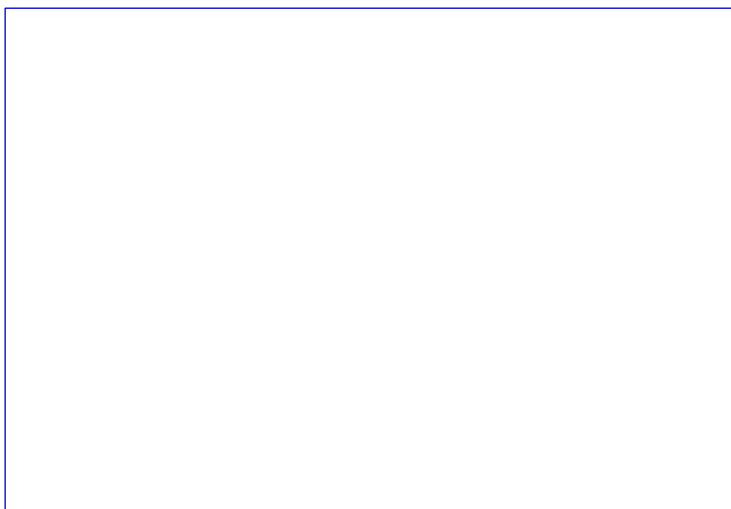
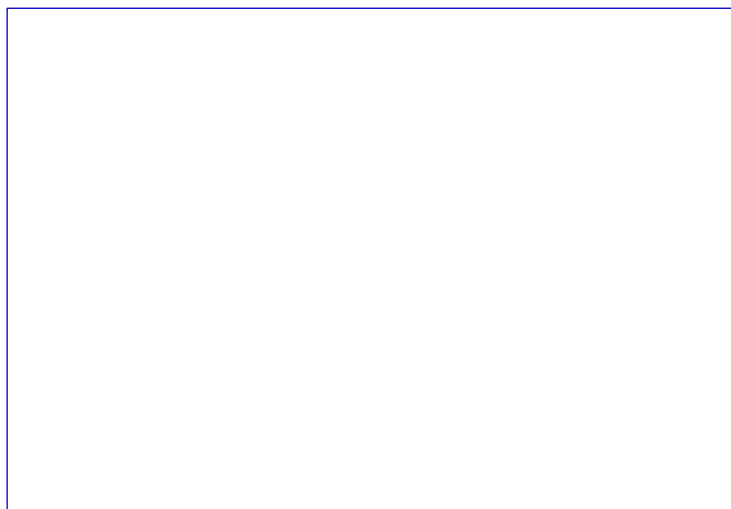
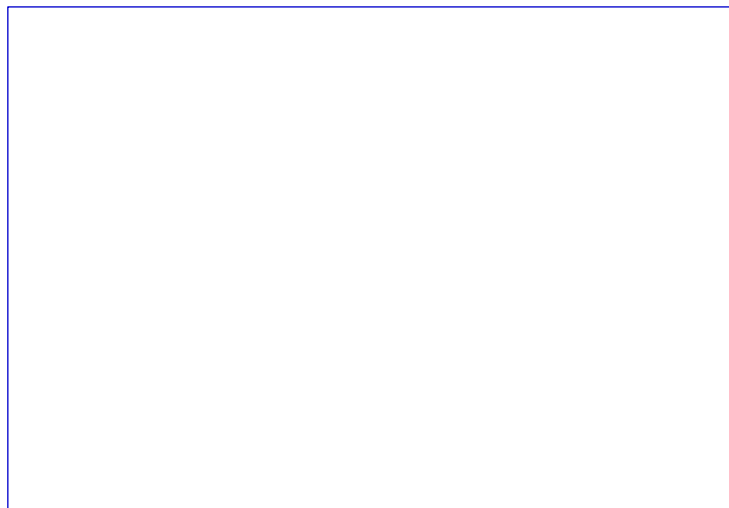

TOTAL APPROX. FLOOR AREA 42.2 SQ.M. (454 SQ.FT.)

Whilst every attempt has been made to ensure the accuracy of the floor plan contained here, measurements of doors, windows, rooms and any other items are approximate and no responsibility is taken for any error, omission, or mis-statement. This plan is for illustrative purposes only and should be used as such by any prospective purchaser. The services, systems and appliances shown have not been tested and no guarantee as to their operability or efficiency can be given

Made with Metropix ©2017